

60W SINGLE OUTPUT INDUSTRIAL DIN RAIL POWER SUPPLY



FEATURES

- Universal AC input/Full range
- Protections: Short circuit / Overload / Over Voltage
- Cooling by free air convection
- Can Be installed on DIN rail TS- 35/7.5 or 15
- UL 508 (industrial control equipment) approved
- Isolation Class II
- LED indicator for power on
- 100% full load burn-in test
- 1 year warranty

SPECIFICATION

OUTPUT

- | | |
|--------------------------------|---|
| • DC VOLTAGE | 24V |
| • RATED CURRENT | 2.5 A |
| • CURRENT RANGE | 0 ~ 2.5 A |
| • RATED POWER | 60 W |
| • RIPPLE & NOISE (max.) Note 2 | 150 mVp-p |
| • VOLTAGE ADJ. RANGE | 21.6 ~ 26.4 V |
| • VOLTAGE TOLLERANCE Note 3 | ± 1.0% |
| • LINE REGULATION | ± 1.0% |
| • LOAD REGULATION | ± 1.0% |
| • SETUP, RISE TIME | 100 ms, 30ms/230VAC ; 200ms,30ms/115VAC at full load. |
| • HOLD UP TIME (Typ.) | 100 ms/230VAC ; 23ms/115VAC at full load. |

INPUT

- | | |
|-------------------------|---|
| • VOLTAGE RANGE | 88 ~ 264 VAC ; 124 ~ 370 VDC |
| • FREQUENCY RANGE | 47 ~ 63 Hz |
| • EFFICIENCY (Typ.) | 84% |
| • AC CURRENT (Typ.) | 1.2 A / 115VAC ; 0.8 A / 230 VAC |
| • INRUSH CURRENT (Typ.) | COLD START 18 A / 115VAC ; 36 A / 230 VAC |

PROTECTION

- | | |
|----------------|--|
| • OVERLOAD | 105 ~ 160% rated output power ; Protection Type: constant current limiting, recovers automatically after fault condition is removed. |
| • OVER VOLTAGE | 27.6 ~ 32.4V Protection Type: Shut down o/p voltage, re-power on to recover. |

ENVIRONMENT

- | | |
|-------------------------|---|
| • WORKING TEMP. | -20 ~ +60°C (Refer to "Derating curve") |
| • WORKING HUMIDITY | 20 ~ 90% RH non - condensing |
| • STORAGE TEMP. UMIDITY | -40 ~ +85°C , 10~95% RH |
| • TEMP. COEFFICIENT | ±0.03%/°(0~50°C) |
| • VIBRATION | 10~500Hz, 2G 10min./1cycle, period for 60 min. each along x,y,z axes; |
| • MOUNTING | Compliance to IEC60068-2-6 |

SAFETY & EMC note 4

- | | |
|------------------------|--|
| • SAFETY STANDARDS | UL60950-1, TUV EN60950-1 approved, design refer to EN50178 |
| • WITHSTAND VOLTAGE | I/P-O/P:3KVAC |
| • ISOLATION RESISTANCE | I/P-O/P: 100M Ohms / 500VDC /25 °C / 70% RH |



- EMC EMISSION
- EMC IMMUNITY

Compliance to EN55011, EN55022 (CISPR22), Class B, EN61000-3-2, -3.
Compliance to EN61000-4-2,3,4,5,6,8,11, EN55024, EN61000-6-2, EN61204-3, heavy industry level, criteria A

OTHERS

- MTBF 215.2K HRS min. MIL-HDBK-217F (25°C)
- DIMENSION 78*93*56mm (W*H*D)
- PACKING 0.3Kg; 48pcs/15.4Kg/1.02CUFT

NOTE

1. All parameters NOT specially mentioned are measured at 230VAC input, rated load and 25°C of ambient temperature.
2. Ripple & noise are measured at 20MHz of bandwidth by using a 12" twisted pair-wire terminated with a 0.1 uf & 47 uf parallel capacitor.
3. Tolerance: includes setup tolerance, line regulation and load regulation.
4. The power supply is considered a component which will be installed into a final equipment. The final equipment must be re-confirmed that it still meets EMC directives.

MECHANICAL SPECIFICATION

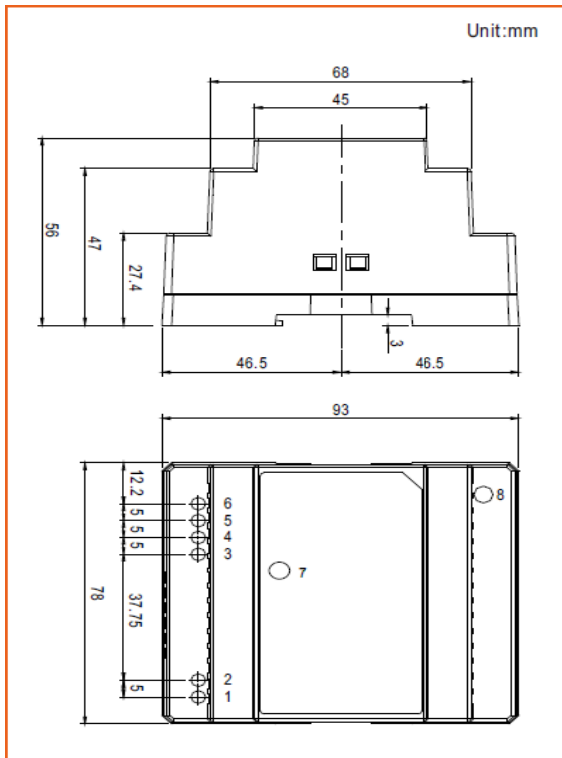

Pin No.	Assignment	Pin No.	Assignment
1	AC/N	5,6	-V
2	AC/L	7	LED
3,4	+V	8	+VADJ.

DERATING CURVE

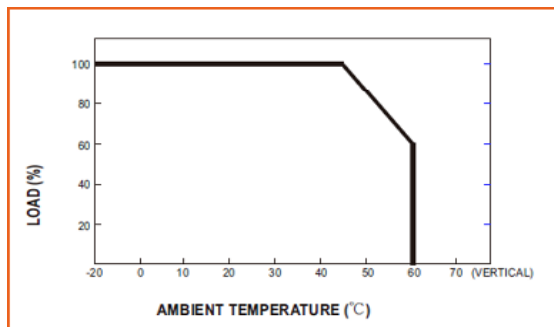

ORDERING CODE:

SIN.AL60W24VDCHD

Sinapsi S.r.l. reserves the right to make changes to this product without any notice

